

ASSEMBLING CONVERTER-MODULE

PRODIGY.MC (rear side)

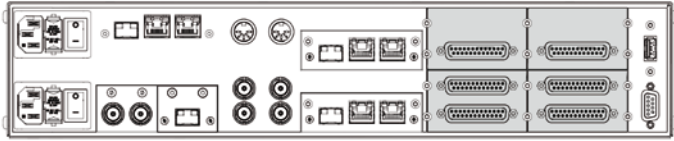

PRODIGY.MP (rear side)



The illustrations are exemplary and may differ from the existing hardware.

 possible slots

WARNING:

The device must be disconnected from the power supply before opening the housing. The modules may be changed only when the device is fully isolated.

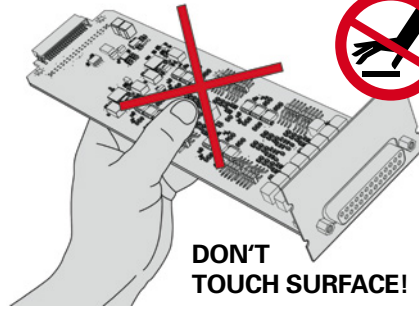
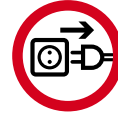

DON'T TOUCH SURFACE!

You need

Torx



T10

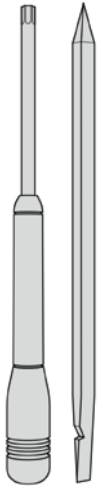

A Device (rear side)

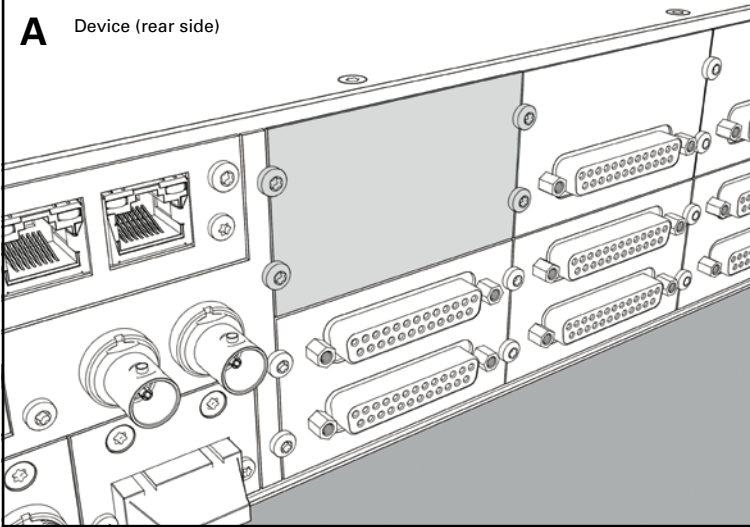

B  Remove Screws 4x

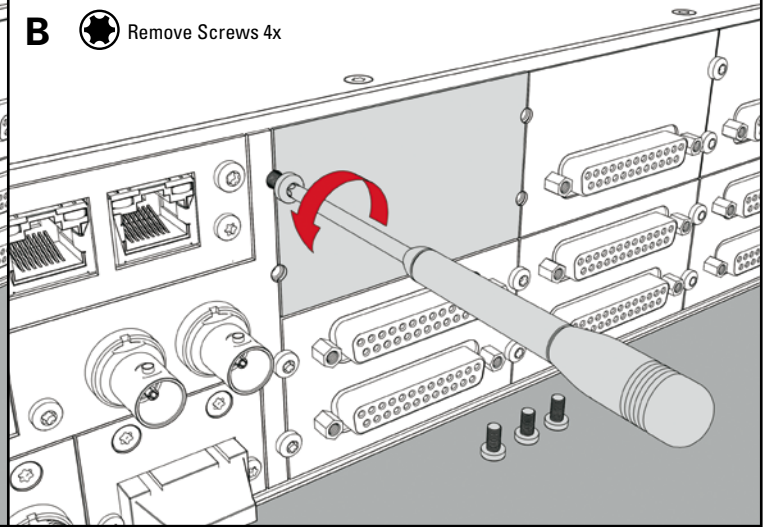

C Remove Cover Plate

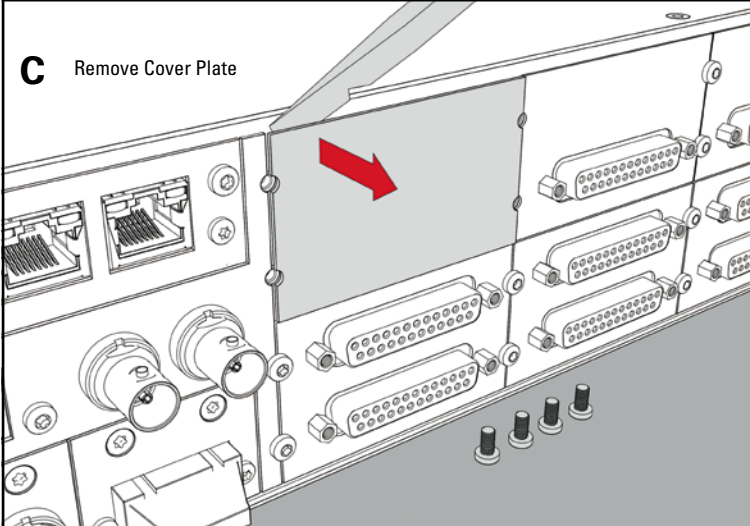

D Insert Converter-Module

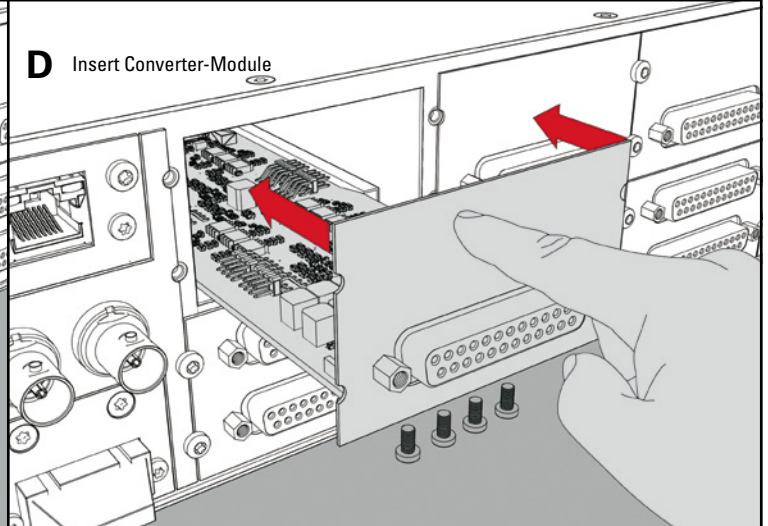

E  Fix Screws 4x

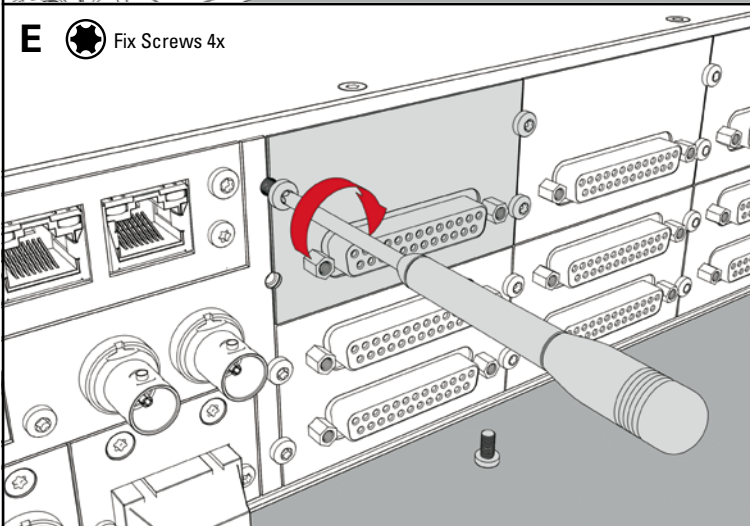

F Ready!

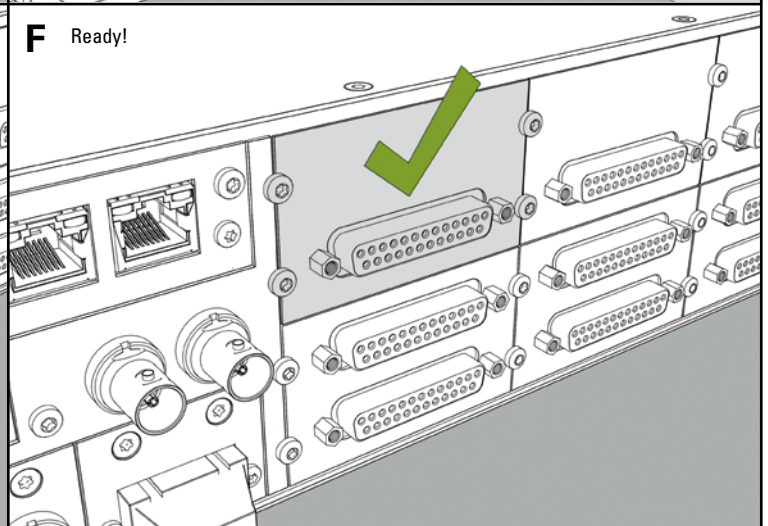

ASSEMBLING NETWORK-MODULE

PRODIGY.MC (rear side)

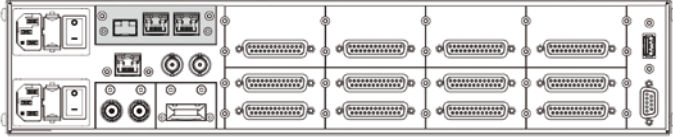

PRODIGY.MP (rear side)

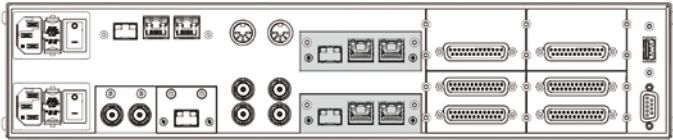

PRODIGY.MX (rear side)



The illustrations are exemplary and may differ from the existing hardware.

 possible slots

WARNING:

The device must be disconnected from the power supply before opening the housing. The modules may be changed only when the device is fully isolated.

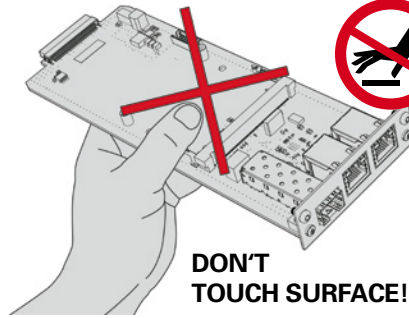
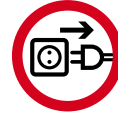

DON'T TOUCH SURFACE!





You need

Torx

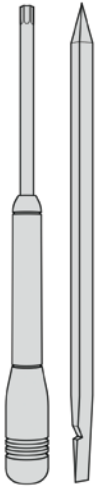

T10



A  Remove Screws 2x

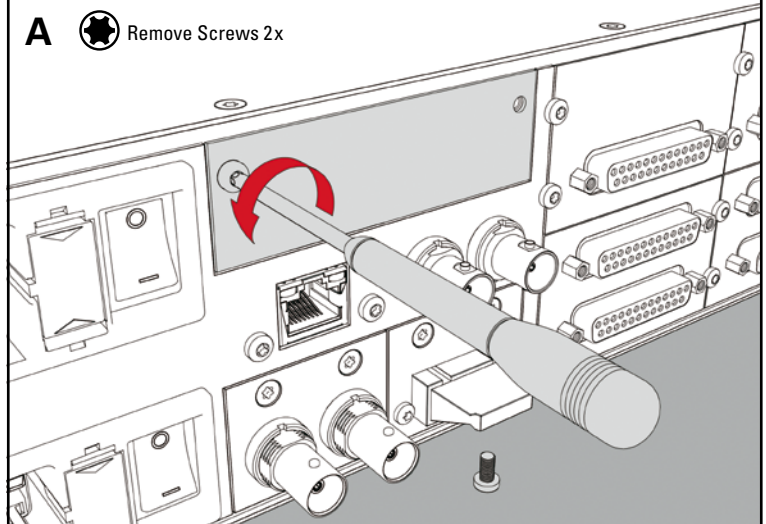

B Remove Cover Plate

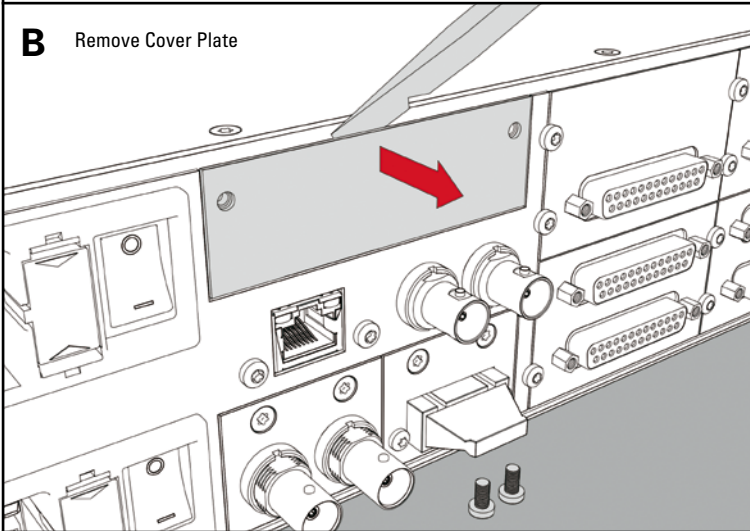

C Insert Network-Module

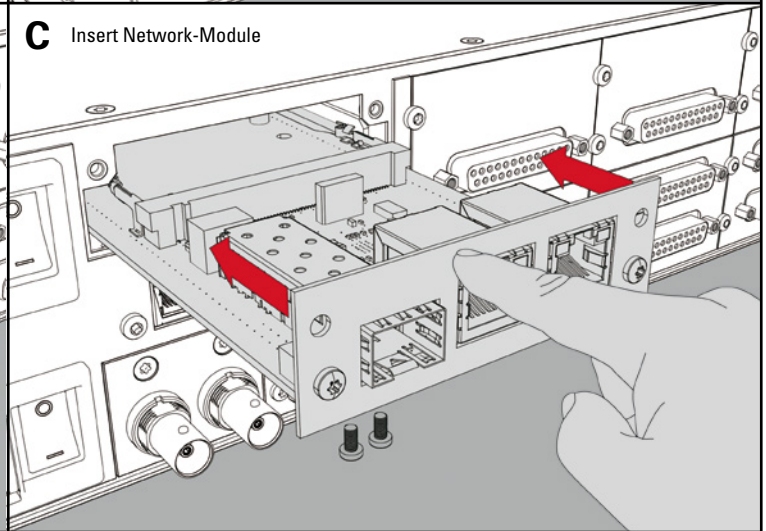

D  Fix Screws 2x

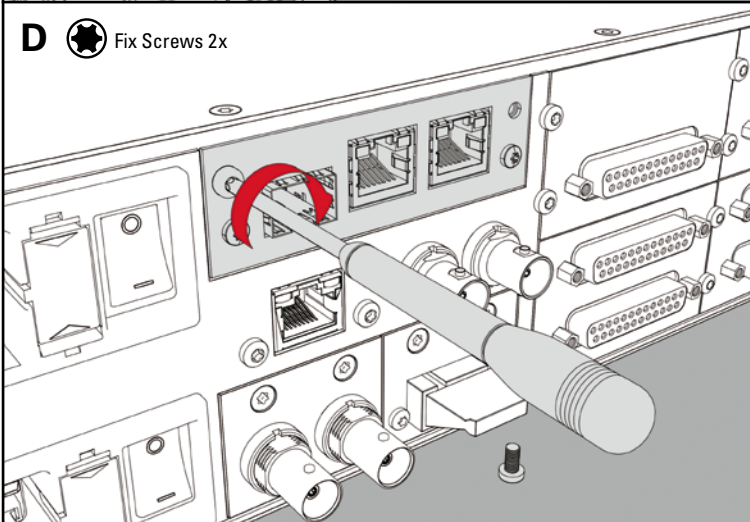

E Ready!

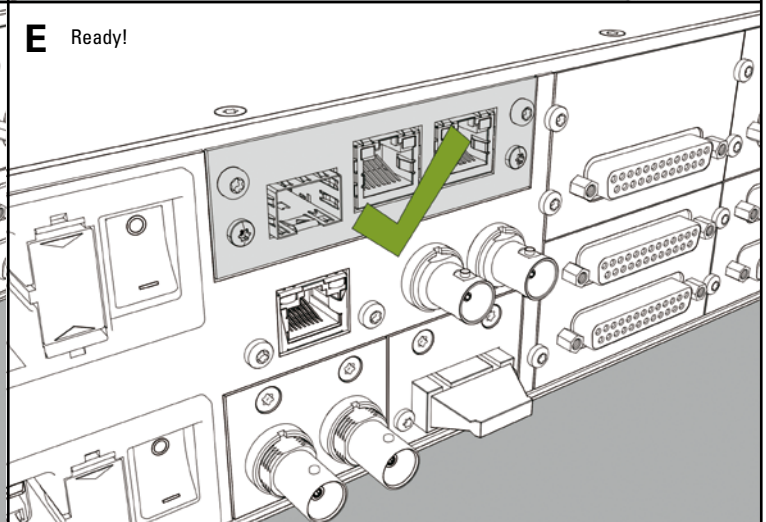

ASSEMBLING MADI-MODULE

PRODIGY.MC (rear side)

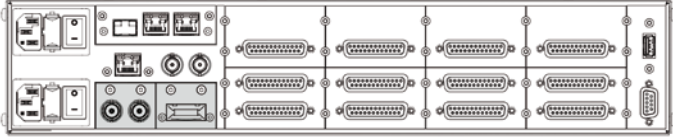

PRODIGY.MP (rear side)

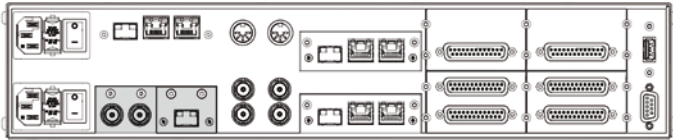

PRODIGY.MX (rear side)

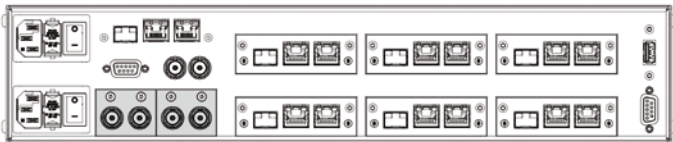

The illustrations are exemplary and may differ from the existing hardware.

 possible slots

WARNING:

The device must be disconnected from the power supply before opening the housing. The modules may be changed only when the device is fully isolated.

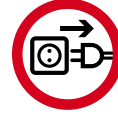

You need

Torx



T10

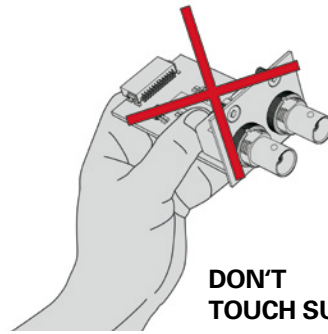
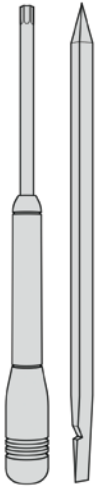

DON'T TOUCH SURFACE!

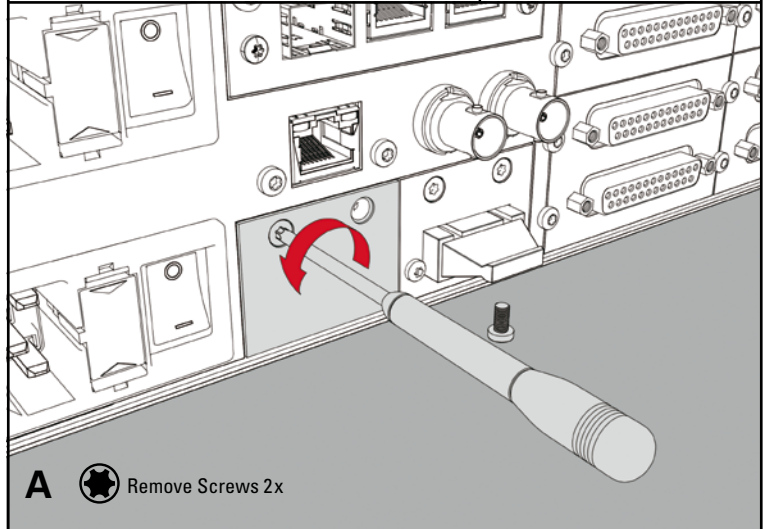

A  Remove Screws 2x

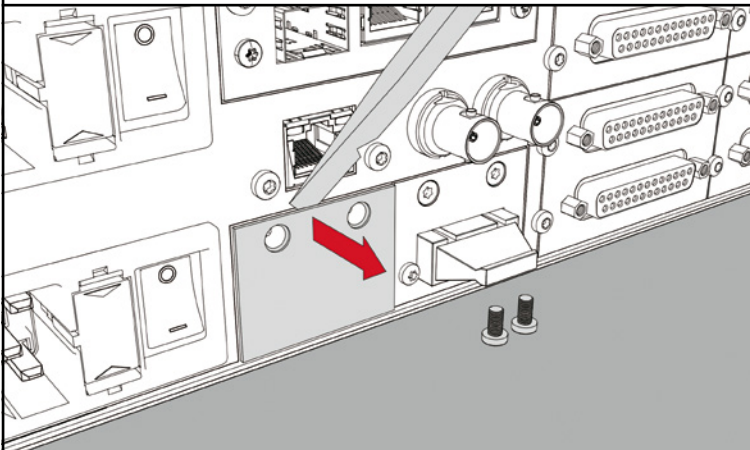

B Remove Cover Plate

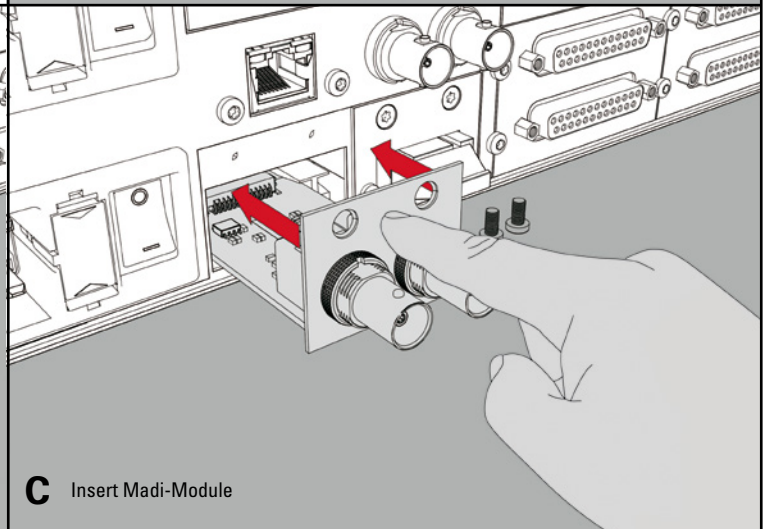

C Insert Madi-Module

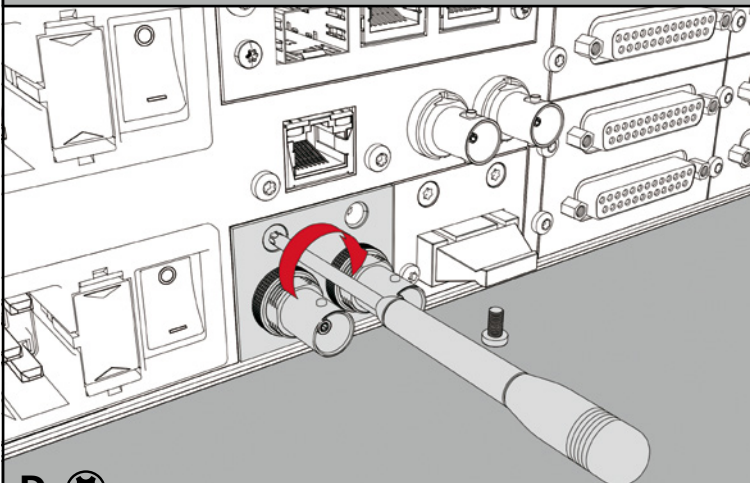

D  Fix Screws 2x

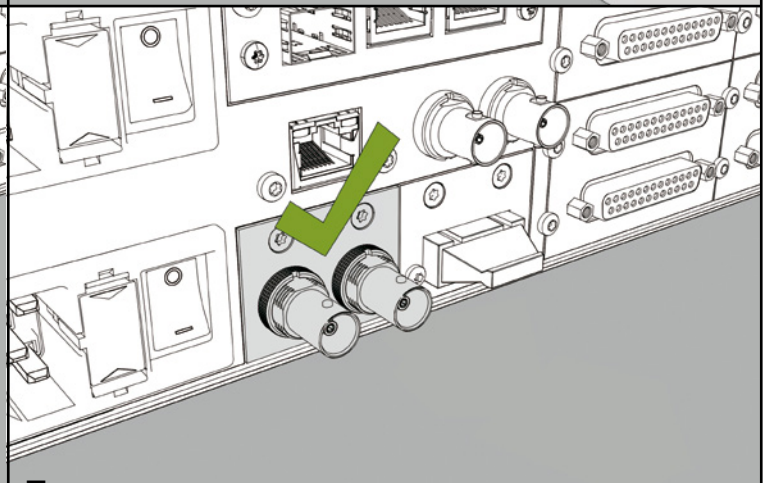

E Ready!